

**NOTES**

- THIS DRAWING IS TO BE READ IN CONJUNCTION WITH ALL ENGINEERS & ARCHITECT'S DRAWINGS FIGURED DIMENSIONS ONLY (NOT SCALING) TO BE USED. WHERE A CONFLICT OF INFORMATION EXISTS OR IF IN ANY DOUBT - "ASK".
- CONSULTANTS TO BE INFORMED IMMEDIATELY OF ANY DISCREPANCIES BEFORE WORK PROCEEDS.

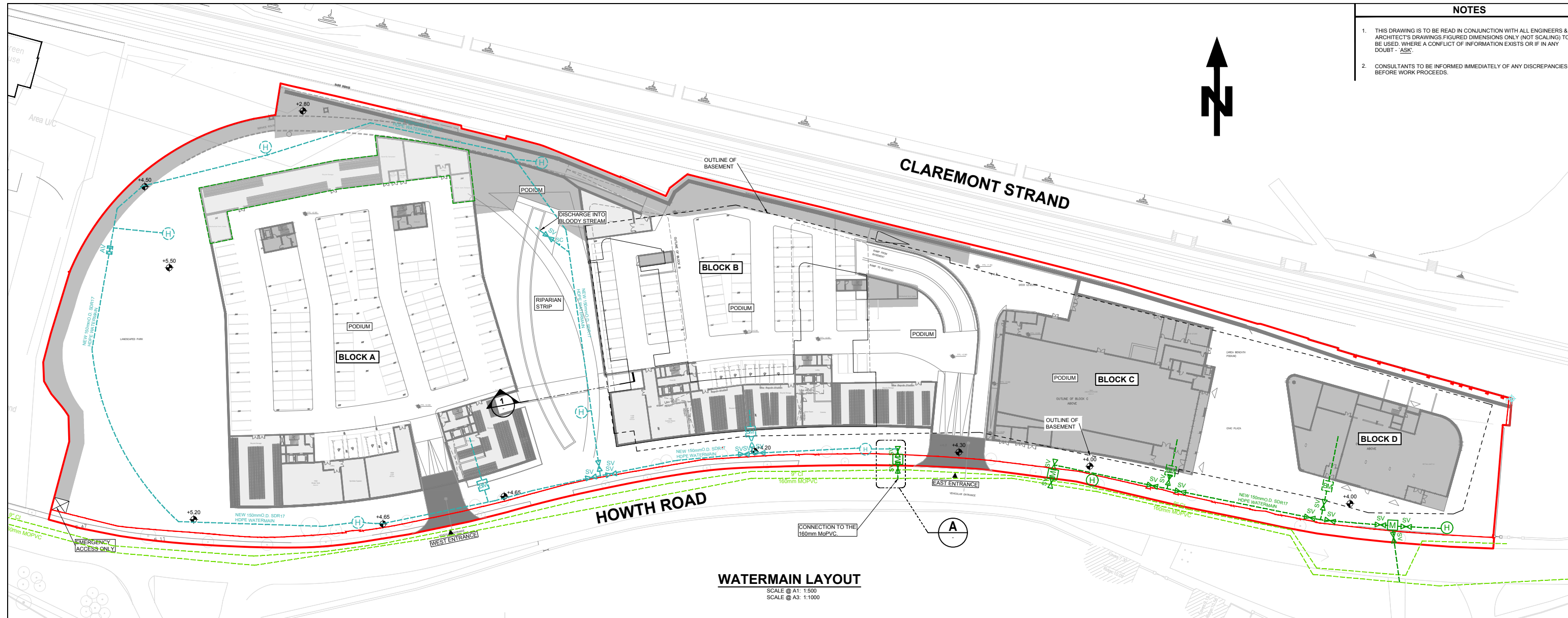

**WATERMAIN LAYOUT**  
SCALE @ A1: 1:500  
SCALE @ A3: 1:1000

WATERMAIN LEGEND	
Ex. WATERMAIN	---
WATERMAIN	---
WATERMAIN NOT TAKEN IN CHARGE	---
SLUICE VALVE	SV
STOP COCK	SC
AIR VALVE	AV
FIRE HYDRANT	H
MAGNETIC FLOW WATER METER	M
BULK METER	EM
IRRIGATION VALVE	IV
TRUST BLOCK	*

- NOTES:**
- REFER TO DRAWING C-1220 FOR STANDARD WATERMAIN DETAILS.
  - ALL HYDRANTS, SLUICE VALVES AND AIR VALVES REQUIRE TOMBSTONES & MARKER PLATES IN ACCORDANCE WITH IRISH WATER REQUIREMENTS.
  - DIAMETER OF HDPE PIPEWORK SHOWN INDICATES OUTER DIAMETER.
  - HYDRANTS AND AIRVALVES TO BE OFF-LINE TYPE.
  - ALL HDPE PIPEWORK TO BE BUTT FUSION WELDED ON SITE IN ACCORDANCE WITH THE SPECIFICATION.
  - REFER TO SPECIFICATION FOR WATERMAINS TESTING & CHLORINATION REQUIREMENTS.
  - WATER METER ARRANGEMENTS TO BE AGREED WITH IRISH WATER.
  - 400mm WIDE WARNING MESH - FLAYGE HR 40D BLUE POLYETHENE OR SIMILAR - TO BE LAID OVER ALL WATERMAIN PIPES 350mm BELOW FGL.
  - 200mm WIDE WARNING MESH TO BE LAID OVER ALL SUPPLY/SERVICE CONNECTIONS 350mm BELOW FGL.
  - ALL PLASTIC PIPES TO HAVE WARNING MESH INCORPORATING A POLYPROPYLENE REINFORCING BAND OF STAINLESS STEEL TRACER WIRE.
  - EXACT LOCATION OF HYDRANTS TO BE AGREED WITH OFFALY COUNTY COUNCIL FIRE OFFICER AS PART OF THE FIRE CERT APPLICATION.

LEGEND	
RAISED PODIUM	□
FIRE TENDER ROAD	▬
MAIN STRUCTURE	□

**NOTE:**  
OFFLINE SCOUR CHAMBER WITH NON-RETURN VALVE CONNECTED TO SURFACE WATER MANHOLE AT LOCAL LOW POINT  
WATERMAIN PIPE MATERIAL SHALL COMPLY WITH SECTION 3.9 OF WATER CODE OF PRACTICE  
NEW WATER INFRASTRUCTURE WILL BE IN ACCORDANCE WITH IRISH WATER CODE OF PRACTICE FOR WATER INFRASTRUCTURE AND IRISH WATER INFRASTRUCTURE STANDARD DETAILS  
FOR STANDARD DETAILS REFER TO PPT-BMC-XX-ZZ-DR-C-1220  
WHERE AIR VALVE AND HYDRANT'S COVERS ARE LOCATED IN GRASS AREAS, THEY SHALL BE SURROUNDED BY A CONCRETE PLINTH, 200mm ALL ROUND AND 100mm DEEP FORMED WITH C20/25 CONCRETE, 20mm AGGREGATE SIZE, BEDDED IN CLAUSE 804 MATERIAL. THE PLINTH SHALL INCORPORATE MILD STEEL REINFORCEMENT LINKS AND SHELL HAVE A BULL-NOSE FINISH AROUND ITS EXTERNAL PERIMETER. SEE SECTION 3.18 OF THE WATER CODE OF PRACTICE.  
NEW WATER INFRASTRUCTURE WILL BE IN ACCORDANCE WITH IRISH WATER CODE OF PRACTICE FOR WATER INFRASTRUCTURE AND IRISH WATER INFRASTRUCTURE STANDARD DETAIL.

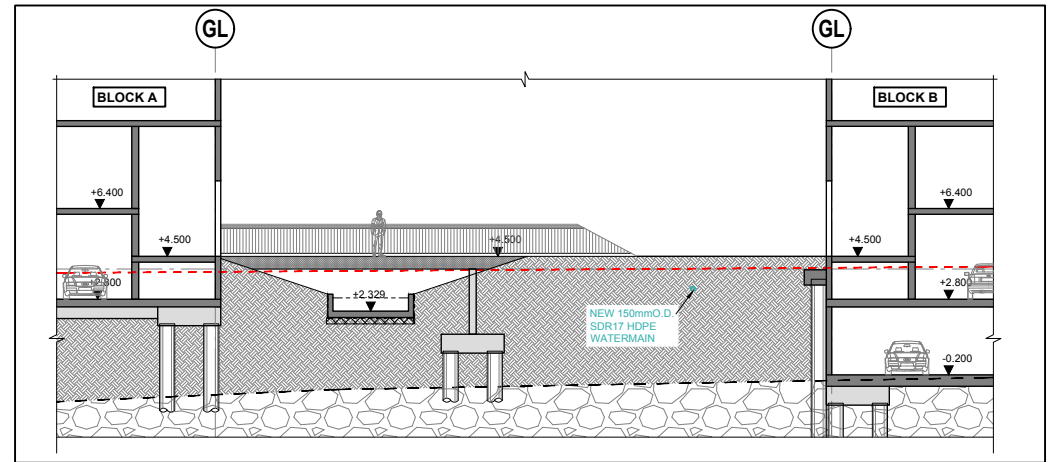

**1 SECTION**  
SCALE @ A1: 1:150  
SCALE @ A3: 1:300

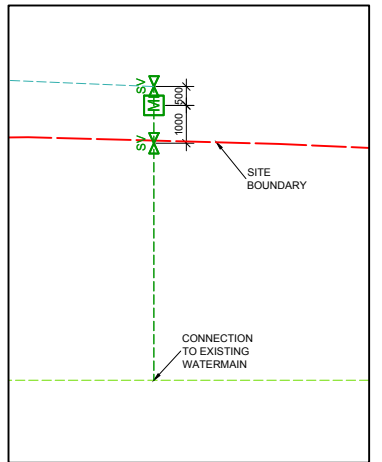

**A DETAIL**  
SCALE @ A1: 1:100  
SCALE @ A3: 1:200

ISSUE	DATE	DESCRIPTION	MR	MS	VB	VL
PL5	26.11.19	ISSUED FOR PLANNING	MR	MS	VB	VL
P8	10.10.19	ISSUED FOR INFORMATION	MR	MS	VB	VL
P7	04.10.19	ISSUED FOR COMMENT	MR	MS	VB	VL
P6	30.09.19	Notch Removed to Irish Water Comments	MR	MS	VB	VL
P5	04.09.19	IRISH WATER COMMENTS	MR	MS	VB	VL
P4	14.08.19	IRISH WATER COMMENTS	MR	MS	VB	VL
P3	15.07.19	ISSUED TO IRISH WATER	MR	MS	VB	VL
PL4	06.06.19	ISSUED FOR PLANNING	MR	MS	VB	VL
PL3	18.04.19	ISSUED FOR COMMENT	MR	MS	VB	VL
PL2	03.04.19	ISSUED FOR COMMENT	MR	MS	VB	VL
PL1	20.03.19	ISSUED FOR COMMENT	MR	MS	VB	VL
P1	08.03.19	ISSUED FOR COMMENT	MR	MS	VB	VL

**DRAWING STAGE: PLANNING**

**BM**  
BARRETT MAHONY  
Consulting Engineers, Civil, Structural, Project Management. E-mail: bmce@bmce.ie Web: www.bmce.ie

**The Institution of Structural Engineers**  
**ACEI**  
International Federation of Consulting Engineers

CLIENT: **ATLAS GP LTD**

PROJECT TITLE: **CLAREMONT PROJECT** BM PROJECT No: **18386**

MODEL REFERENCE: MODEL REV: SUITABILITY:

DRAWING TITLE: **WATERMAIN LAYOUT**

DRAWING No: **PPT-BMD-XX-ZZ-DR-C-1005** ISSUE: **PL5**